



**NEW ITEM**  
**2015**  
**TRIAL PROMO**  
 01 Sep. ~ 25 Dec. 2015

**BUY 1 HOLDER**  
**GET 2 INSERTS Free**



• Micro grain carbide insert, one insert has 2 cutting edges.



## NC Helix Drill

### Helical Interpolation



Only six tools for making  $\varnothing 13 \sim \varnothing 65$  mm hole

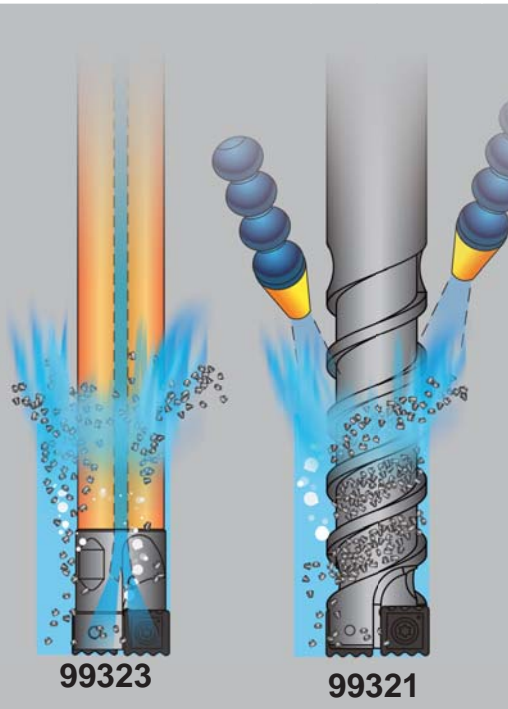

#### ➤ Titanium

Special geometry insert to cut different materials. For almost all kind of materials, excellent for soft and long cutting chip materials, such as low carbon steel, stainless steel and Titanium.

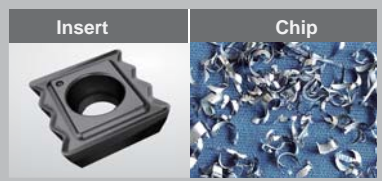

#### ➤ Job has various hole diameters & Step Holes

The hole is cut by helical interpolation. Just one tool can machine different diameters and depth of holes.

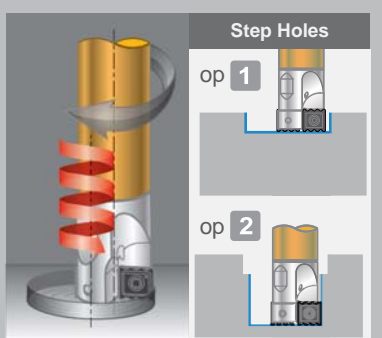

#### ➤ Lower Spindle Power Consumption Easy Cut!

Thanks to the small cutting load of the serrated cutting edge and helical interpolation, low power consumption of the spindle is required. Circular ramping milling, maximum ramping angle is  $20^\circ$ .

